

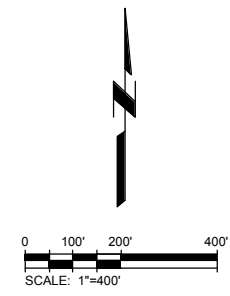

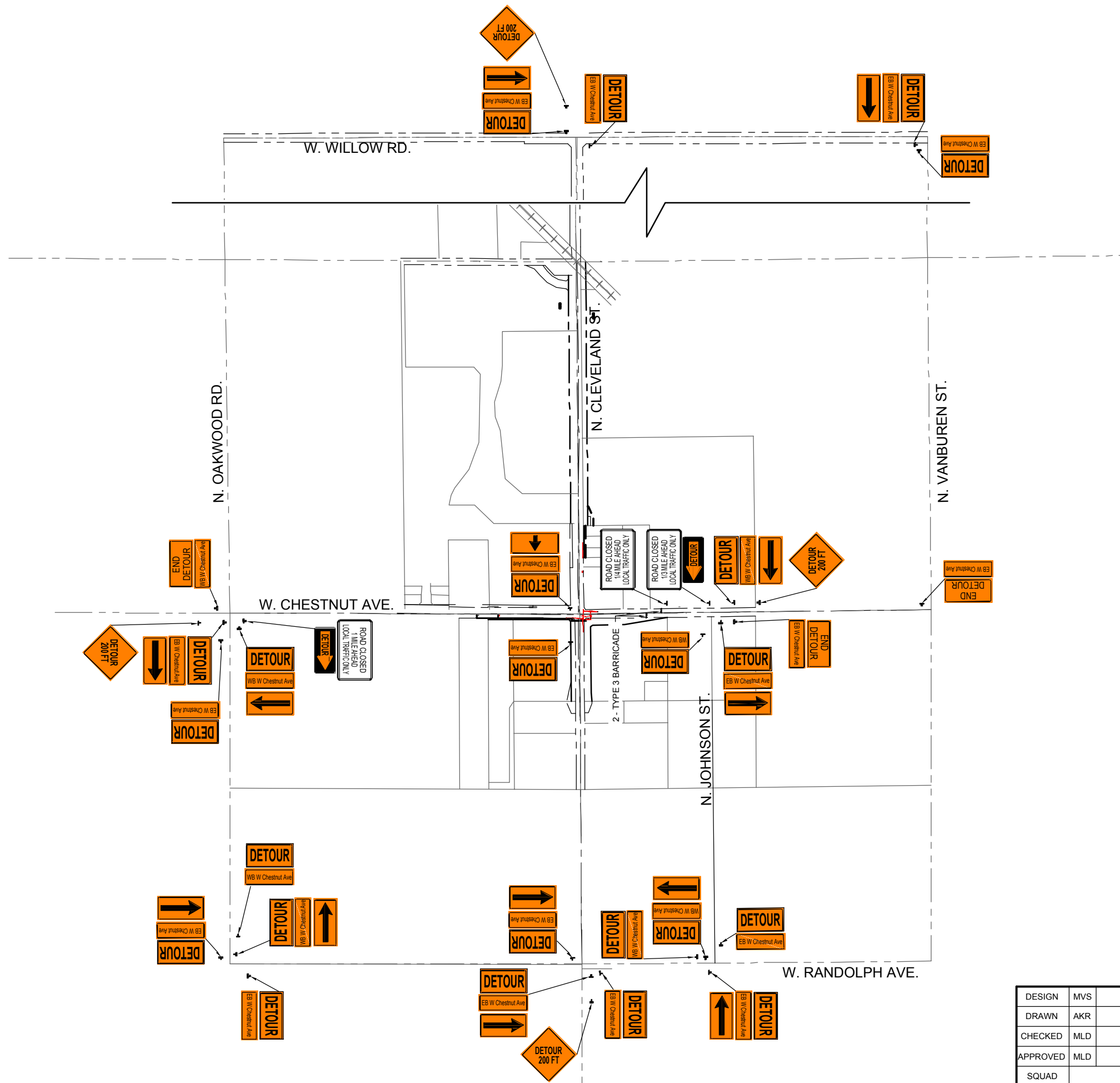



9/22/2017 2:05:53 PM - P:\277121\131-27712-13001\CAD\ISHEETFILES\WATERLINE PLANS\DET ROUTING-PH2.DWG - SCHUMACHER, MIKE

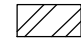
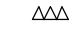

REFERENCE THE 2009 MUTCD FIGURE 6H-9 FOR
DETOUR ROUTE SIGNAGE & 2012 SUPPLEMENT
FIGURE D3-1 FOR STREET NAME SIGNAGE.
REFERENCE ODOT STANDARDS:
TCS1-1, TCS2-1, TCS3-1, TCS4-1, TCS5-1 & TCS6-1.

CONTRACTOR SHALL MAINTAIN
ACCESS TO ALL BUSINESSES
AND DRIVEWAYS

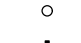
LEGEND

-  WORK COMPLETED PREVIOUS PHASE
-  WORK AREA
-  TYPE III BARRICADE w/ TYPE "A" WARNING LIGHTS R11-2 (LANE)
-  DRUMS w/ W1-8(L)
-  CHANNELIZING CONE
-  SIGNAGE
-  DIRECTION OF TRAVEL

DESIGN	MVS
DRAWN	AKR
CHECKED	MLD
APPROVED	MLD
SQUAD	

CITY OF ENID

**TCP - SEQUENCE OF CONSTRUCTION
DETOUR ROUTING - PHASE 2**

CITY PROJECT: W-1406B

SHEET NO. 13
GARFIELD COUNTY